

Espay Solar Energy S.L.

Photovoltaic panel battery model difference diagram



Solar Panel



PV Combiner Box



Lithium Battery



Hybrid Inverter



Overview

Diagrams, examples, and schematics for wiring solar panels in series and parallel and schematics for wiring batteries in series and parallel. Understanding a solar and lithium battery storage system diagram is fundamental to grasping how your energy independence is achieved. This schematic serves as the blueprint for your entire power system, detailing every component and connection. It is an invaluable tool for installation. Our hope is to help you narrow down which type of solar battery best suits your needs so you can focus your search on one or two specific brands or models. The most popular home solar batteries are lithium-ion. For example, a 100W solar panel can make (under standard test conditions, STC) 18 volts (V) and 5. Have you decided to install your own photovoltaic system but don't know where to start?

We have produced a number of connection diagrams for the various components of a solar photovoltaic system. Solar panels Batteries Communication diagram Schematic diagram Solar kits There are no more items in. Ever wondered why two identical solar installations can have 20% efficiency differences?

The answer often lies in their photovoltaic panel battery arrangement diagrams - the blueprint determining how energy flows from sunlight to storage. As solar adoption grows 23% annually (2023 Gartner Emerging.

Photovoltaic panel battery model difference diagram



Schematics: Wiring Solar Panels and Batteries in Series and Parallel

Diagrams, examples, and schematics for wiring solar panels in series and parallel and schematics for wiring batteries in series and parallel.

What Are The Different Types Of Solar Batteries?

Two things to keep in mind are the type of battery you're looking for and what exactly you want to get out of your battery. There are four types of solar batteries: lead-acid, lithium-ion, nickel cadmium, and ...



How to Read a Solar & Lithium Battery Storage System Diagram

A detailed guide on interpreting solar and lithium battery system diagrams. Understand the key components and their connections for effective energy management.

The Ultimate Solar Panel System

Schematic Diagram: A ...

Overall, a solar panel system schematic diagram provides a visual representation of how the different components of a solar panel system work together to generate and store solar energy. It is a helpful ...

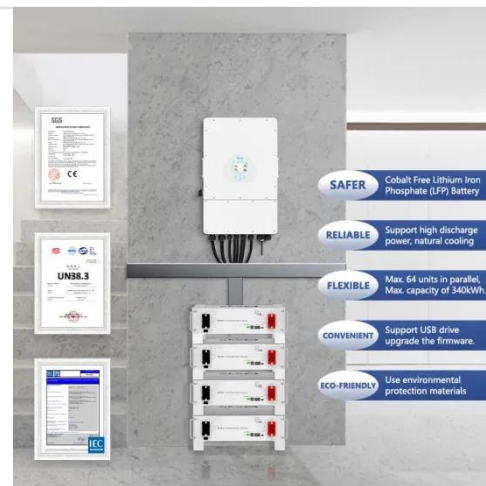

Illustration of a Solar Battery System

Learn about solar battery systems and explore a diagram of how they work, including components like solar panels, inverters, and battery storage.

Photovoltaic Panel Battery Arrangement Diagrams: Optimizing Solar

Ever wondered why two identical solar installations can have 20% efficiency differences? The answer often lies in their photovoltaic panel battery arrangement diagrams - the blueprint determining how ...



Solar installation

Have you decided to install your own photovoltaic system but don't know where to start? We have produced a

number of connection diagrams for the various components of a solar photovoltaic system.



Types of Solar Batteries in 2026: A Comprehensive Guide

Explore the main types of solar batteries available in the residential market to guide your battery shopping and achieve your energy goals.



What Are The Different Types Of Solar Batteries?

Types of Solar Batteries
Dc-Coupled vs Ac-Coupled Solar Batteries
How to Find The Right Solar Battery Type For You
There are four main types of battery technologies that pair with residential solar systems: 1. Lead acid batteries 2. Lithium ion batteries 3. Nickel based batteries 4. Flow batteries Each of these battery backup power technologies has its own set of unique characteristics, making them best for different types of solar systems. Let's take a closer See more on solarreviews altE

Schematics: Wiring Solar

Panels and Batteries in ...

Diagrams, examples, and schematics for wiring solar panels in series and parallel and schematics for wiring batteries in series and parallel.

Schematic diagram

Schematic diagram Input 1: 1 string of 5 *HIH* Longi HiMo5 405W Mono PV panels (Black Frame White Backsheet) Input 2: 1 string of 6 *HIH* Longi HiMo5 405W Mono PV panels



Solar Power System Diagram and Components Explained

Explore the key components and layout of a solar power system, including solar panels, inverters, and battery storage, with a detailed diagram for better understanding.

Contact Us

For catalog requests, pricing, or partnerships, please visit:
<https://espay.es>

