

**Espay Solar Energy S.L.**

# **How to bear the load of photovoltaic panel factory**



## Overview

---

Learn how to assess roof load for factory solar installations. 5 kg per panel per square foot). Mounting system: Adds about 10–15 kg/m<sup>2</sup>, depending on material and type. Ballasted systems: On flat roofs, ballasts may add additional load. However, before installing a PV system, it's essential to consider the additional loads these panels place on your building's structure, and how this can affect your property in the long-term. In this post, we'll explore the key factors to understand about PV panel loading on industrial buildings. Adding a solar array to your roof is more than just an electrical project; it's a structural one. You are introducing significant weight and a new profile that interacts with wind and weather. A proper Structural Load Analysis is the engineering discipline that ensures your roof can handle these. According to the Insurance Institute for Business & Home Safety (IBHS), your roof should be able to support 20-pounds of snow, per square foot, before the roof is 'stressed. ' The IBHS goes on to explain that "10-12 inches of snow is equal to. " However, if you have. That whole system—the panels, the racks, the wiring—has to be engineered to survive.

## How to bear the load of photovoltaic panel factory

---



### Structural Requirements for Solar Panels -- Exactus Energy

This comprehensive guide outlines the structural requirements for solar panels and provides an overview on the inner workings of the installation process.

### Assessing Your Roof's Load-Bearing Capacity for Solar Panels

Calculating your roof's load-bearing capacity involves assessing the weight of the solar panels, considering structural support elements, and potentially reinforcing the roof to meet the ...



### Solar Panel Loading on Industrial Buildings

In this post, we'll explore the key factors to understand about PV panel loading on industrial buildings, and how proper engineering ensures your investment is safe, efficient, and built to last.

### Can The Factory Roof Bear The Weight Of Solar Panels?

Learn how to assess roof load for factory solar installations. Understand panel weight, mounting, structural factors, and reinforcement options.

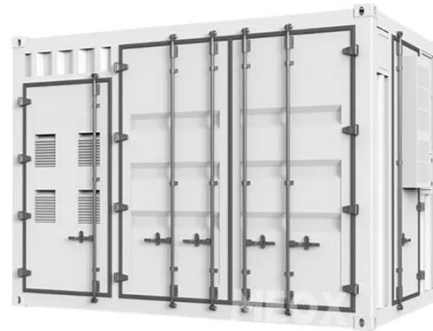

## Roof Load Distribution Calculations for Solar Panel Structural Safety

Solar panel weight can vary based on panel type and size, making understanding roof load distribution essential for homeowners and solar contractors. Factors such as roof material, ...

## Understanding Roof Load Capacity for Solar Panels

Learn more about all you need to know about roof loads, load capacities and how they determine if a roof can support the weight of solar panels. Roof load capacity is simply a ...

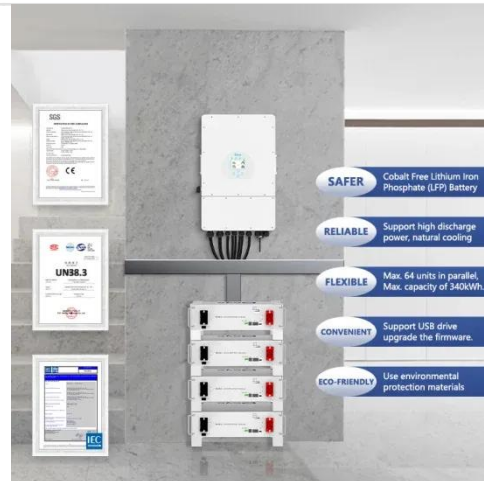

## CAN YOUR ROOF HANDLE THE WEIGHT OF SOLAR PANELS?

The roof must be able to support the sum of its dead load and any anticipated live load, so the roof has to be designed



with a load limit that takes into account both of these loads.

## The load-bearing photovoltaic panels installed on the roof of the ...

In this guide, we'll explain a typical solar panel installation from start to finish, as well as what all the hardware does, and where on your property you can install the panels.

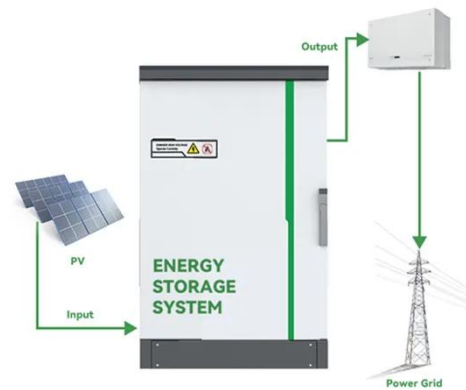

## Specifications for laying photovoltaic panels on factory roofs

Boyue Photovoltaic Technology Co., Ltd is located in Hebei Province, China, the factory covers an area of 18,000 square meters, and 150 workers, 66 kilometers away from Beijing Airport and 180 ...

## Structural Load Analysis

A complete guide to structural load analysis for solar panel installations. Learn about load types, mounting, and ensuring roof integrity.



---

## Contact Us

For catalog requests, pricing, or partnerships, please visit:  
<https://espay.es>

